**STO20**

Yoke type track roller

Yoke type track rollers STO, without axial guidance, outer ring without ribs

Technical information

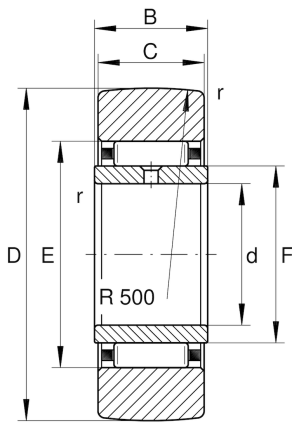

Main Dimensions & Performance Data

d	20 mm	Bore diameter
D	47 mm	Outside diameter
C	15.8 mm	Width, outer ring
C _{rw}	16,100 N	Basic dynamic load rating, radial
C _{0rw}	22,000 N	Basic static load rating, radial
C _{urw}	3,100 N	Fatigue load limit, radial
n _{DG}	2,400 1/min	Speed on permanent grease lubrication
≈m	0.158 kg	Weight

Dimensions

B	16 mm	Width, inner ring
E	32 mm	Raceway diameter outer ring
r _{min}	0.3 mm	Minimum chamfer dimension
F	25 mm	Raceway diameter inner ring
R	500 mm	Radius of outer ring outside profile